



LOVE LIVES HERE QUILT BLOCK

Read all instructions before cutting fabrics.

- RST = Right Sides Together
- WOF = Width of Fabric
- Cutting instructions are based on 40" WOF.
- Use scant 1/4" seam allowances
- Refer to the pattern cover and diagrams for fabric placement.
- Label pieces as you cut.
- Sew with RST unless otherwise stated.
- Press seams as desired unless stated otherwise.
- Dimensions listed in steps are unfinished sizes unless stated otherwise.

FABRICS BY RILEY BLAKE DESIGNS

- Hush Hush 4 - Quilly Pleasure (Fabric 1)
- Shades Cobalt (Fabric 2)

MATERIALS

For 1 block:

- 1/2" fabric
- 1/2" fabric

PART OF RILEY BLAKE'S "FROM OUR HOME"
 pattern from Riley Blake Designs
 the block from fabric design
 Love Lives Here

6" X 6" FINISHED BLOCK

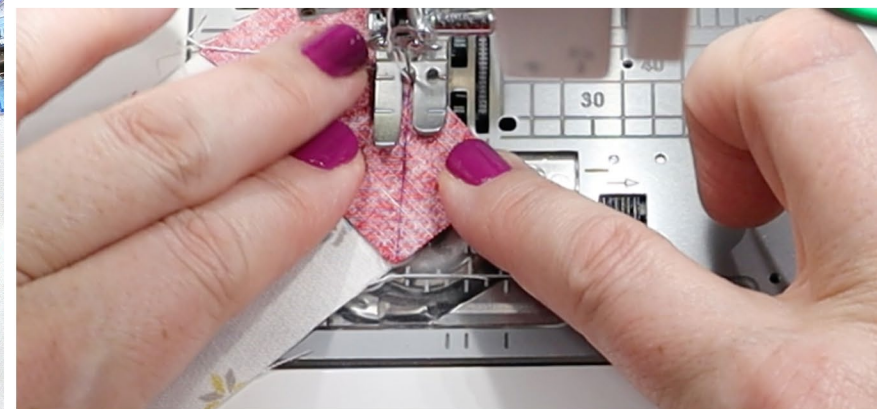

Tara
Reed

TaraReed.com & SewWithTaraReed.com

Love Lives Here Quilt Block

Finished Block Size: 6" x 6" - Unfinished Block Size: 6 1/2" x 6 1/2"

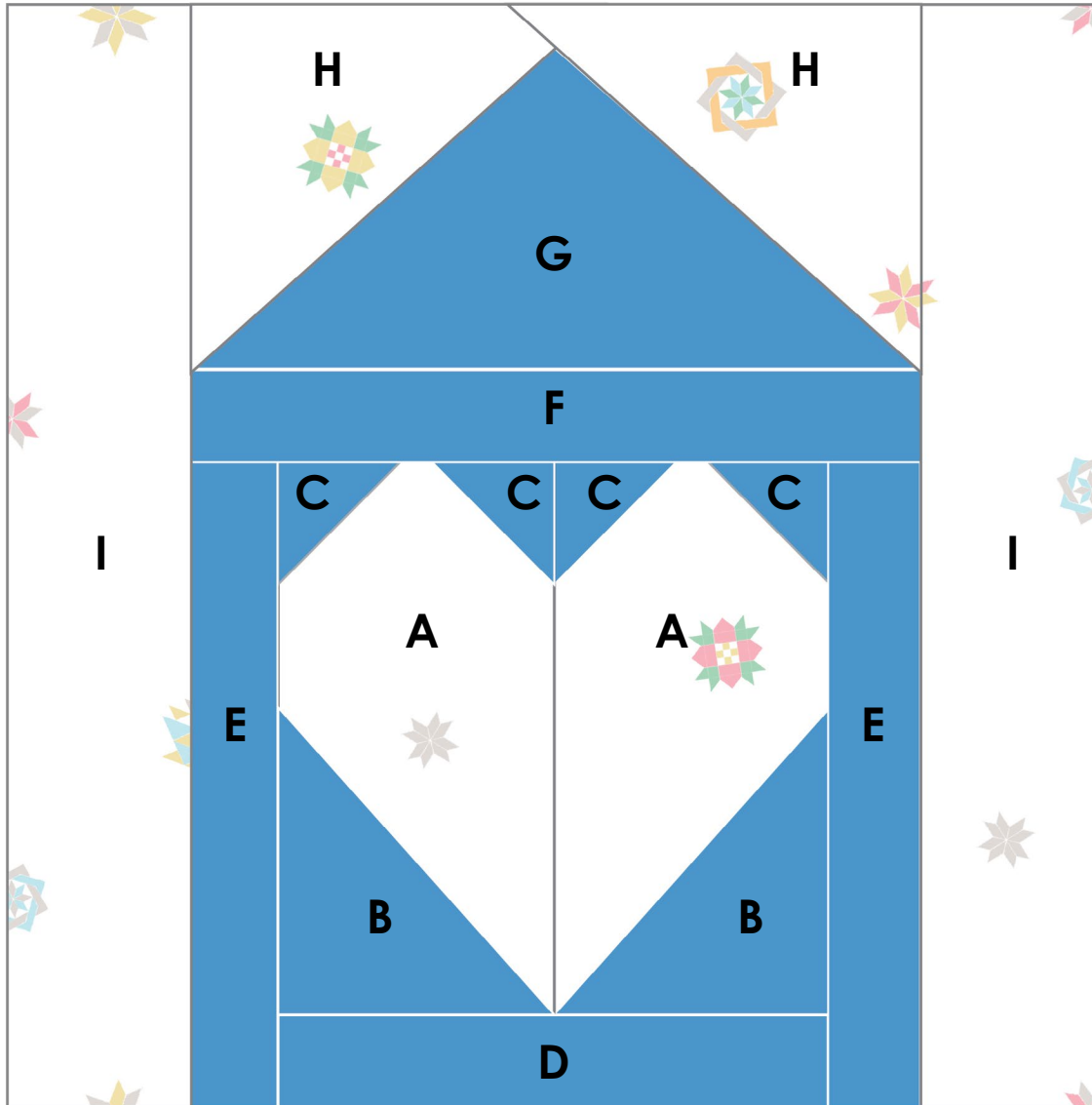

THIS BLOCK IS PART OF RILEY BLAKE'S "FROM OUR HOUSE" QUILT SEW ALONG

You can find the [pattern from Riley Blake Designs here](#) and follow their blog to find an alternate block from fabric designers like me each week.

Read all instructions before cutting fabrics.

- RST = Right Sides Together
- WOF = Width of Fabric
- Cutting instructions are based on 40" WOF.
- Use scant 1/4" seam allowances
- Refer to the pattern cover and diagrams for fabric placement.
- Label pieces as you cut.
- Sew with RST unless otherwise stated.
- Press seams as desired unless stated otherwise.
- Dimensions listed in steps are unfinished sizes unless stated otherwise.

FABRICS BY RILEY BLAKE DESIGNS

- Hush Hush 4 - Quilty Pleasure (Fabric 1)
- Shades Cobalt (Fabric 2)

MATERIALS

Fabric 1:

- A: (2) 2" x 3 1/2"
- H: (2) 2 1/2" x 2 1/2"
- I: (2) 1 1/2" x 6 1/2"

Fabric 2:

- G: (1) 4 1/2" x 2 1/2"
- F: (1) 4 1/2" x 1"
- E: (2) 1" x 4"
- D: (1) 3 1/2" x 1"
- B: (2) 2" x 2"
- C: (4) 1" x 1"

[Watch the Video Tutorial on YouTube](#)

STEP 1: MAKE THE 3½" X 3½" CENTER HEART BLOCK

- Draw a diagonal line on the wrong side of all B and C squares.
- Place (2) B squares on (2) A rectangles, RST and with the marked lines as shown.
- Sew on the lines.
- Trim corners leaving ¼" beyond the stitching.
- Flip the B pieces right side up and press. The size of the larger, original base piece does not change.

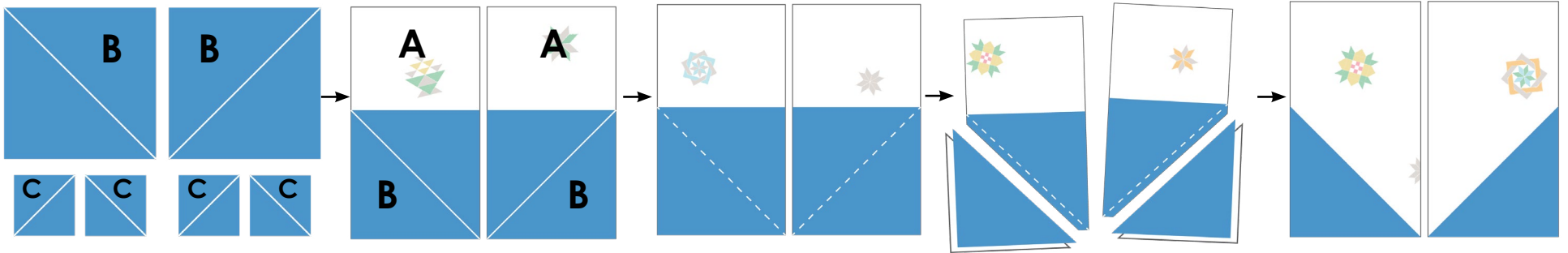

- Place (4) C squares on (2) A/B units, RST and with the marked lines as shown.
 - Sew on the lines.
 - Trim corners leaving ¼" beyond the stitching.
 - Flip the C pieces right side up and press.
- Sew the two halves of the heart block RST and press the center seam open.
 - The heart block should measure 3½" x 3½".

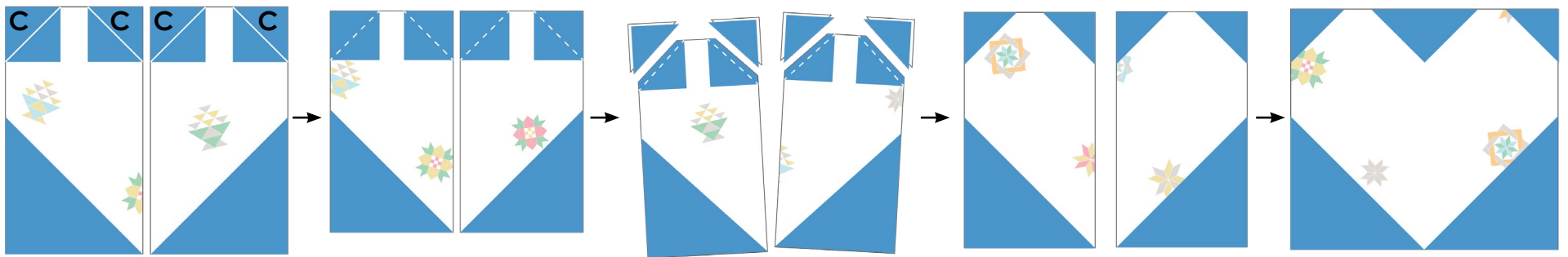

STEP 2: MAKE THE ROOF

- Draw a diagonal line on the wrong sides of (2) H squares.
- Place (1) H square on top of (1) G rectangle, RST with the marked line as shown.
- Sew on the lines.
- Trim corners leaving ¼" beyond the stitching.
- Flip the H piece right side up and press.

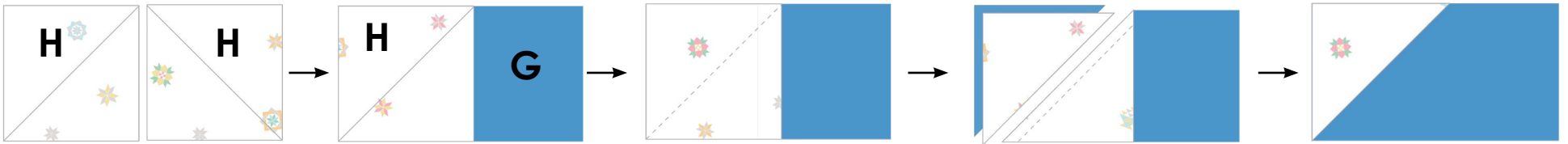

- Repeat the steps with the other H piece on the opposite side to complete the roof, as shown.

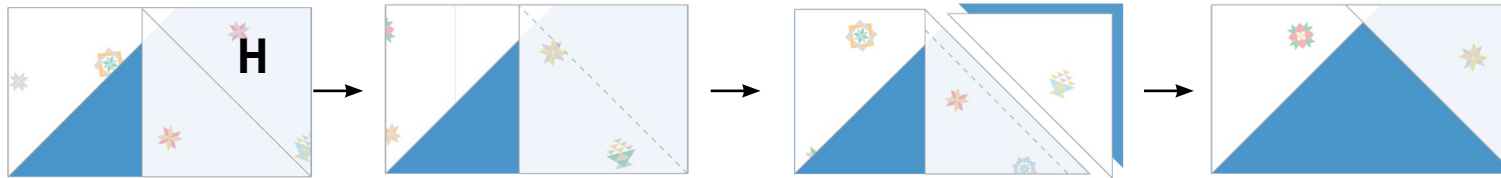

STEP 3: ASSEMBLE THE HOUSE UNIT

- Sew (1) D rectangle to the bottom of the heart unit.
- Sew (2) E rectangles to each side as shown.
- Sew (1) F rectangle to the top as shown.
- Sew the roof unit on top to complete the house unit as shown.

STEP 4: ASSEMBLE THE BLOCK

- Sew an I rectangle to each side to complete the block.
- The unfinished block should measure 6 ½" x 6 ½".

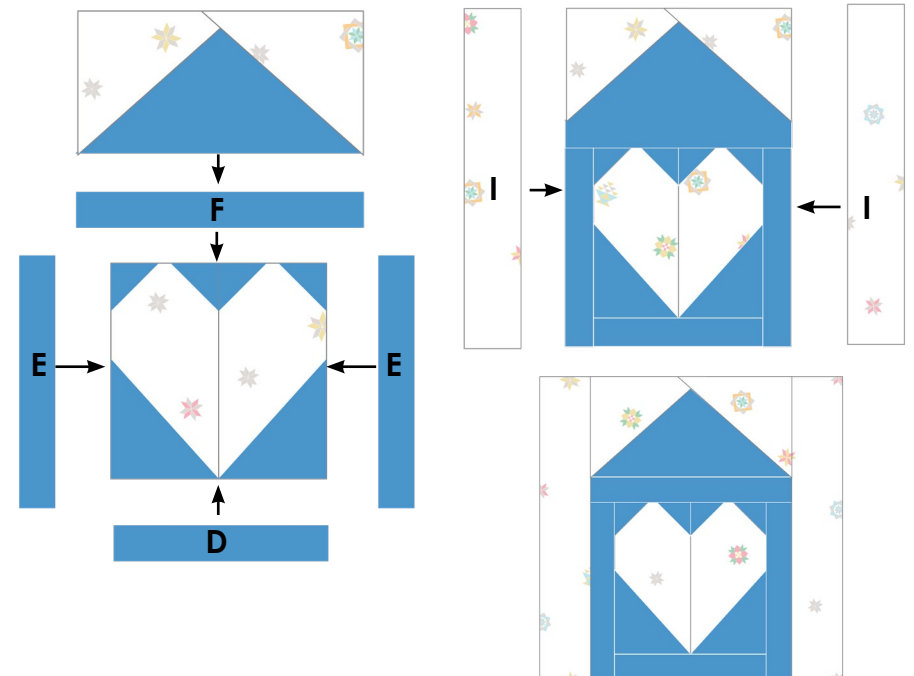

Enjoy and share your quilt using the hashtags #hushhush4fabric #fromourhousequilt #tarareeddesigns #rileyblakedesigns and #iloverileyblake

WHAT IF THERE WAS A PLACE...

- ✓ with lots of sewing & quilting tutorials, projects and patterns
- ✓ with NO ADS
- ✓ with a supportive community of others who love to sew and quilt
- ✓ with exclusive content, live events and fun
- ✓ INSTANT ACCESS TO IT ALL ON DAY 1!

Join me for an ONGOING PROGRAM filled with monthly projects that go beyond the basics. You will get the inspiration and motivation to truly MAKE and ADVANCE your skills to the next level!

LEARN MORE ABOUT IT

HERE IS A SAMPLING OF WHAT YOU WILL FIND



IN CASE WE HAVEN'T MET BEFORE...

Hi! I'm Tara Reed and I've been creating art and design professionally since 2000.

I design fabric for Riley Blake and have a passion for making sewing fun for beginners and intermediate sewists and quilters.

Thank you for allowing me to be a part of your creative life!

Tara Reed

Let's Connect!



If you are a Cricut, Silhouette or Scan 'N Cut creative as well as sewist or quilter, be sure to visit my Etsy shop for Crafts.

© Tara Reed Designs Inc - SewWithTaraReed.com | TaraReed.com | Etsy Shop
You can make and sell PHYSICAL products using my patterns. Do not share the patterns in whole or in part, even as a freebie.
You may not alter, reproduce, resell, or claim any of the files as your own or upload to any file sharing website.