

LOVE YOU QUILT BLOCK

By: Amber Johnson of Gigi's Thimble

Notes: All seam allowances are $\frac{1}{4}$ ". Finished block size = 6".

CUTTING:

From 8 different Hush Hush 4 low-volume fabrics, cut:

1 rectangle, 2" x 3 $\frac{1}{2}$ " (8 total)

From 1 bright background fabric, cut:

4 squares, 1 $\frac{1}{2}$ " x 1 $\frac{1}{2}$ "

2 squares, 3 $\frac{1}{2}$ " x 3 $\frac{1}{2}$ "



ASSEMBLY:

1. Sew together 2 sets of 4 low-volume rectangles as shown. Press the seam allowances toward the arrows.

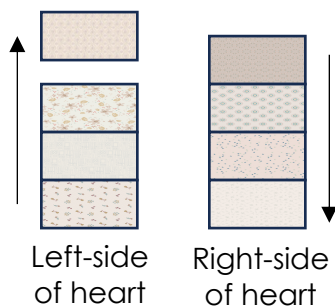

2. Draw a diagonal line from corner to corner on the wrong side of the bright background squares. Place a 1 $\frac{1}{2}$ " marked square on each of the top corners and a 3 $\frac{1}{2}$ " marked square on the bottom of the unit as shown and stitch on the drawn lines.

Trim $\frac{1}{4}$ " from the stitching lines. Press the seam allowances open. This is the left-side of the heart block. Repeat this process on the right-side of the heart block.

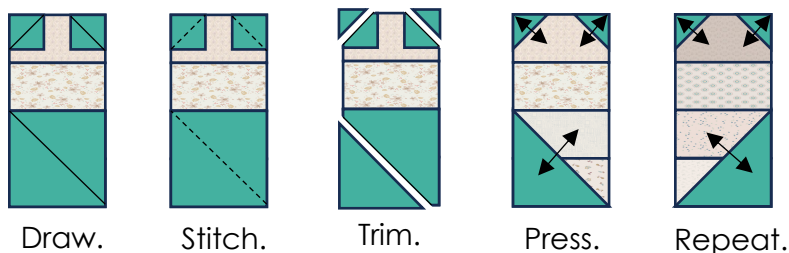

3. Sew the two sides of the heart block together and press the seam allowances open. The block should measure 6 $\frac{1}{2}$ " x 6 $\frac{1}{2}$ " unfinished.

©Copyright 2024 Gigi's Thimble. Please do not reproduce in any way without written consent from Gigi's Thimble. ALL RIGHTS RESERVED.